



Kallesoe Machinery

and

System TM

invite you to join
us for an

Open House

where we will showcase
the latest production
solutions in the timber
processing and
mass timber market

June 13 – 17, 2022

Kallesoe Machinery | Bredgade 115
6940 Lem | Denmark
kallesoemachinery.com

System TM | Skovdalsvej 35
8300 Odder | Denmark
www.systemtm.com



Member of the HOMAG Group



System TM

If you're curious about how our innovative solutions for mass timber production come about, then this is your chance to get a look behind the scenes.

We are pleased to invite you to our open house event this June. Come join us for a guided tour through our production halls, where you'll get an exclusive look at one of our newest projects – a massive CLT facility.

Our open house will take place at Kallesoe Machinery from June 13 – 17, 2022.

The event will be held in collaboration with our sister company System TM, and you will be able to visit their company as well. The event is a perfect opportunity for you to discover the latest news and developments within Mass Timber and Timber Processing.



At Kallesoe you will find state-of-the-art production lines for Mass Timber

You'll gain insight into our production processes, and how we progress from design, construction, assembly, and testing to ship-off.

We'll take you on a guided tour of our production facilities, where we'll show a wide variety of the newest state-of-the-art production lines for mass timber.

The tour will include a look into some of the most essential parts of a massive CLT production plant that we are currently working on for our customer in Austria.

You'll be surrounded by experts in highly advanced machinery, so there'll be plenty of opportunity for asking questions and to gain the latest knowledge from our industry.

We look forward to seeing you!



Come and experience what will evolve into the next generation of CLT presses.

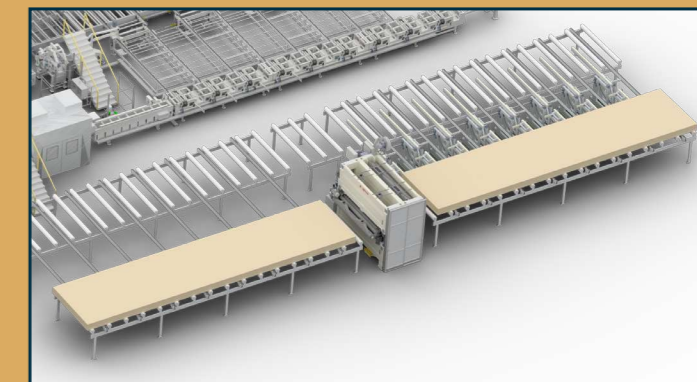
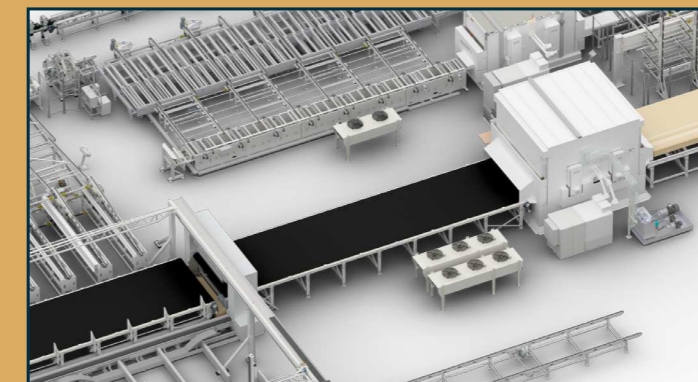
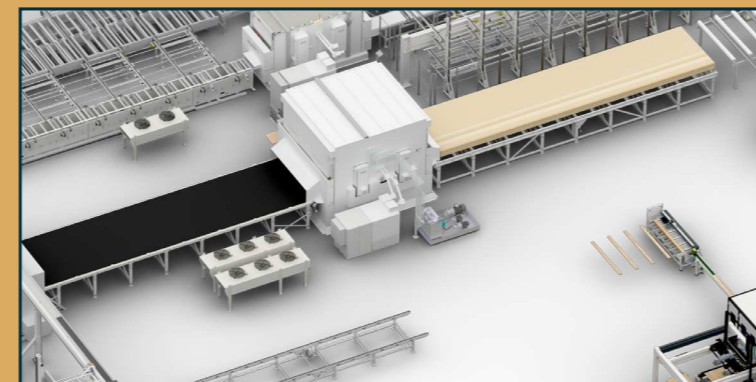
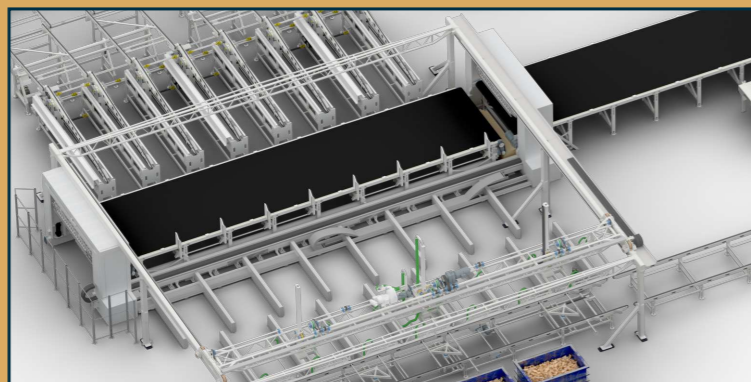

Join us at System TM for a live demonstration of the Opti-Joint H-L finger-jointer in action! Our latest product development, the Opti-Joint H-L, is a state-of-the-art finger-jointing machine, designed to make long length lamellas for glue-laminated beams and CLT wall production.

We will showcase an Opti-Joint H-L line consisting of two shaper units, an alignment station, and a continuous press. After the continuous press, a flying saw unit will cut the lamellas into specified lengths.

Presenting the Opti-Joint H-L, a new finger-jointer for long length production

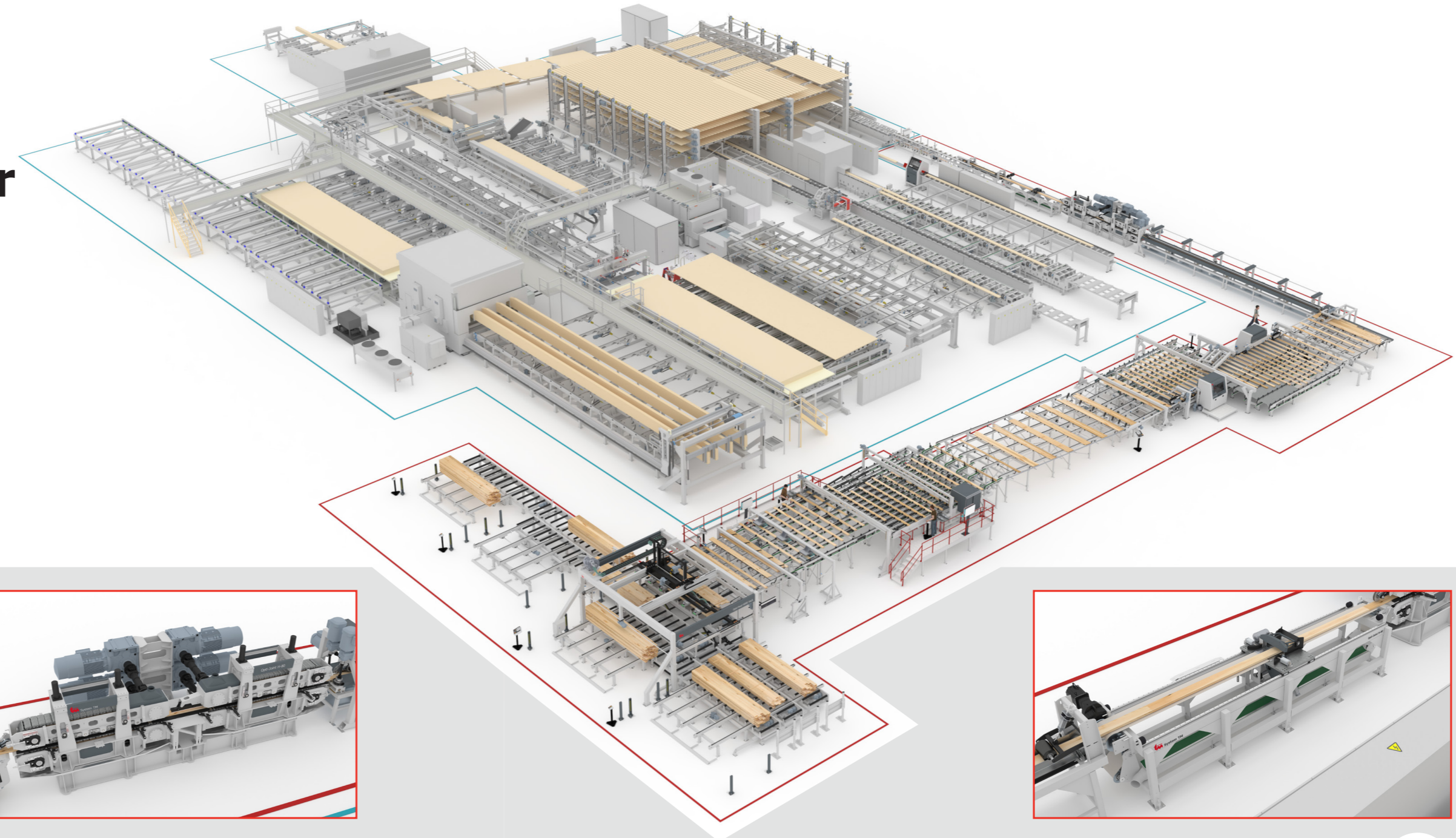

We will also take you on a tour around System TM to show you our production facilities and ongoing projects. Our Open House is a perfect opportunity for you to discover the latest news and developments within mass timber and timber processing.

We hope to see you there!

Join Us for an Exclusive Behind-The-Scenes Look at How We Do What We Do



Kristian Kallesøe
CEO



Bruno Kallesøe
Senior Advisor



Jens Kallesøe
CSO



Jens Therkildsen
Sales Manager



Jon Kræmer
Sales Assistant



Per Jørgensen
CSO



Per Juul Jensen
Area Sales Manager



Allan Them
Area Sales Manager



Peter Simonsen
Area Sales Manager



Jean-Luc Croteau
Area Sales Manager

Best Regards



Member of the HOMAG Group



Daniel Bentzen
Area Sales Manager



Dennis Steffensen
In-house
Sales Engineer



Michael Brandt
In-house
Sales Engineer

Best Regards



System TM

Registration

To secure your spot at this event, you can either fill out our sign-up form by following the link in this email or by using the below QR code.



The deadline for registration for this event is no later than **Monday, May 23rd**.

Spots will be allocated on a first-come, first-serve basis. Further details will follow to those who sign up.